

Children's Battery-Powered Tractor

Owner's Manual

Product appearance and colors may vary from the photo.

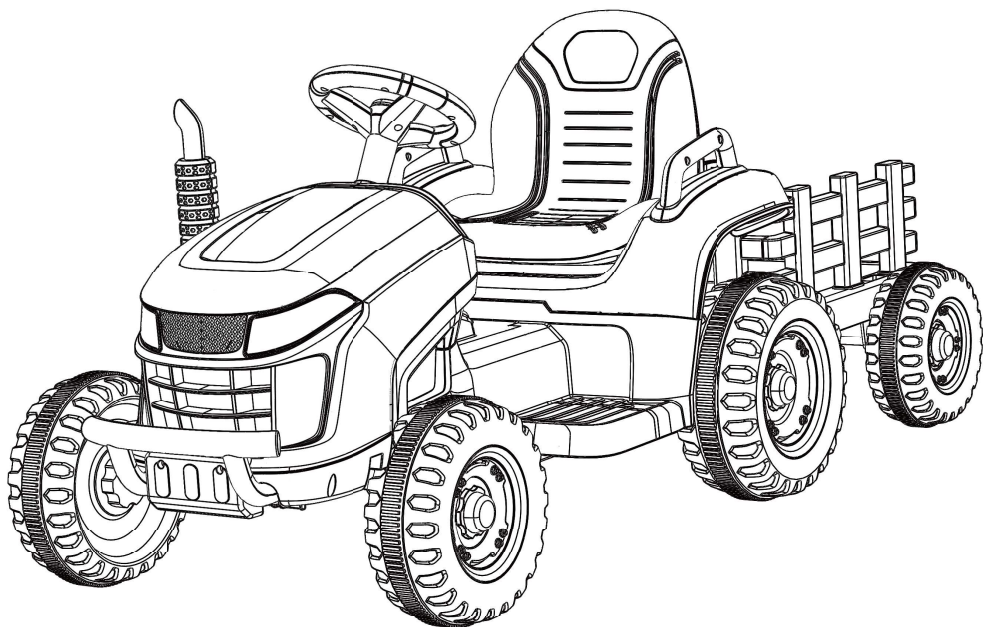

www.jollyroom.com/contact



Please read the owner's manual carefully.



1

About Your New Ride-On



This Manual was written to help you and your child get the most performance, comfort, enjoyment and safety when riding your new electric ride-on toy. It is important for you to understand your new electric ride-on toy. By reading this manual before you let your child go out on his/her first ride, you will know how to get the most from your new electric ride-on toy. It is also important that you or your child's first ride be in a controlled environment, away from cars, obstacles, and other riders.

SPECIFICATIONS:

Battery:	12V 4.5 AH *1 or 12V 7 AH *1
Charger:	input: AC 100-240V / 50-60Hz output: DC 12 - 15V
Suitable age:	3-8 years
Load Capacity:	Under 30kg
Speed:	3.2-7 km/h
Size of car:	139 * 58 * 55 CM
Power way:	Charging type
Charge time:	8-10 hours

WARNING!

This toy must be assembled by an adult.

WARNING!

The remote control is not a toy, and is only allowed to be operated by adults.



WARNING!

- CHOKING HAZARD - Small parts. Not suitable for children under 36 months. The product contains small parts, keep children away when assembling.
- ADULT ASSEMBLY REQUIRED.
- Always remove protective material and poly bags and dispose before assembly.
- Recommended protective equipment (helmet, gloves, knee-pads, elbow-pads, etc). Protective equipment should be worn. Always wear shoes and sit in the seat when operating the vehicle.
- Only drive on level ground. Never use on the lawn.
- Keep your hands, hair, and clothes away from moving parts.
- Never leave child unattended. Direct adult supervision is required. Always keep child in view when child is in vehicle.
- To reduce the risk of injury, adult supervision is required. Never use in roadways, near motor vehicles, on or near steep inclines or steps, swimming pools or other bodies of water, always wear shoes, and never allow more than 1 rider.
- Never use in unsafe conditions such as snow, rain, loose dirt, mud, sand, or gravel, otherwise may result in an unexpected accident such as tipping over, and could damage the electrical system or battery
- Not to be used in traffic.
- This toy should be used with caution since skill is required to avoid falls or collisions causing injury to the user or third parties.
- This toy is unsuitable for children under 36 months due to its maximum speed; Maximum user weight is 30kg.
- This toy has no brake.
- Use only battery(ies) and charger specified by the manufacturer. Using another battery or charger may cause a fire or explosion. Do not use the battery or charger for any other product.

BATTERY INFORMATION

- Non-rechargeable batteries are not to be recharged.
- Rechargeable batteries are to be removed from the toy before being charged.
- For the remote control, rechargeable batteries are only to be charged under adult supervision.
- Different types of batteries or new and used batteries are not to be mixed.
- Batteries are to be inserted with the correct polarity.
- Exhausted batteries are to be removed from the toy.
- The supply terminals are not to be short-circuited.

3

Parts Diagram

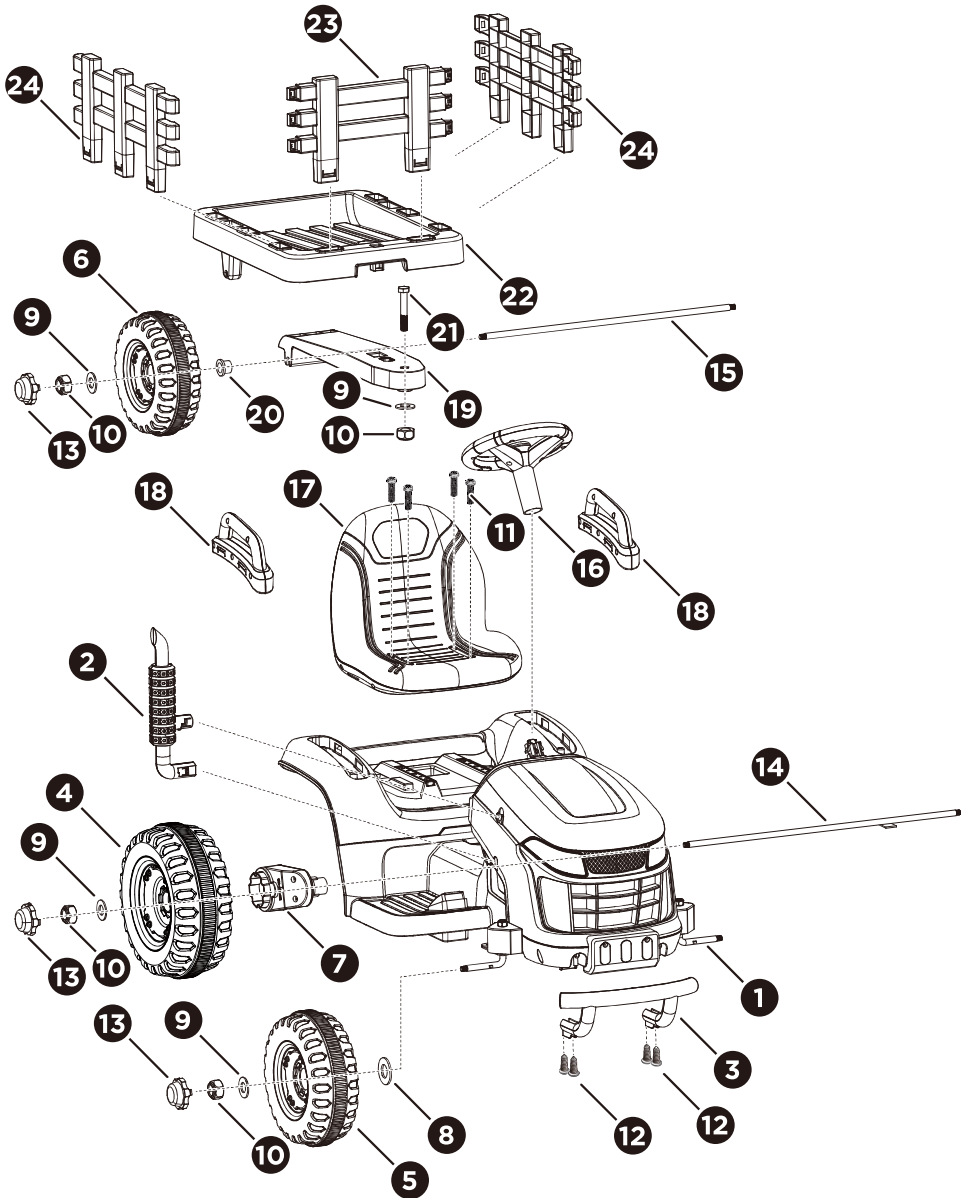

4

Parts List



1 Vehicle body
x1

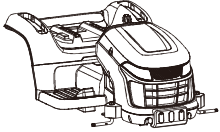

2 Chimney
x1

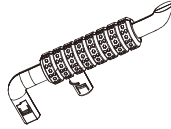

3 Bull bar
x1

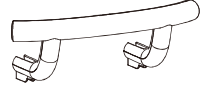

4 Driving wheel (A)
x2

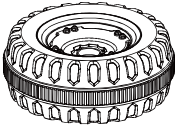

5 Front wheel (B)
x2

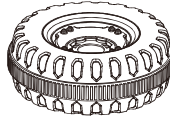

6 Trailer wheel (C)
x2

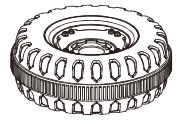

7 Gear box
x2

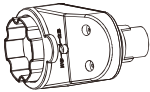

8 M10 washer
x2



9 M8 washer
x7



10 M18 lock nut
x8



11 M4x20 machine screw
x4

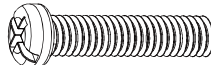

12 #4x12 screw
x4

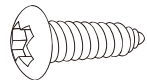

13 Hub cap
x6



14 Rear axle
x1



15 Trailer axle
x1



5

Parts List



16 Steering wheel
x1



17 Seat
x1



18 Arm rest
x2

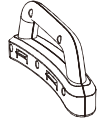

19 Tow bar
x1

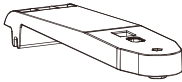

20 M8x45 bolt
x1



21 Bushing
x2



22 Trailer body
x1

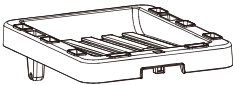

23 Front rail
x1

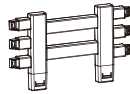

24 Side rail
x2

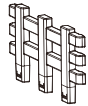

25 Socket wrench
x2

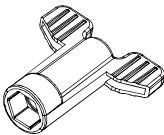

26 Charger
x1

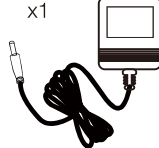

27 Remote controller
x1

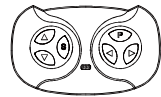

Assembly tools required:

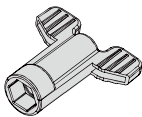

Socket wrench
(Included)



Screwdriver
(Not included)



Scissors
(Not included)

6

Assembly Instruction

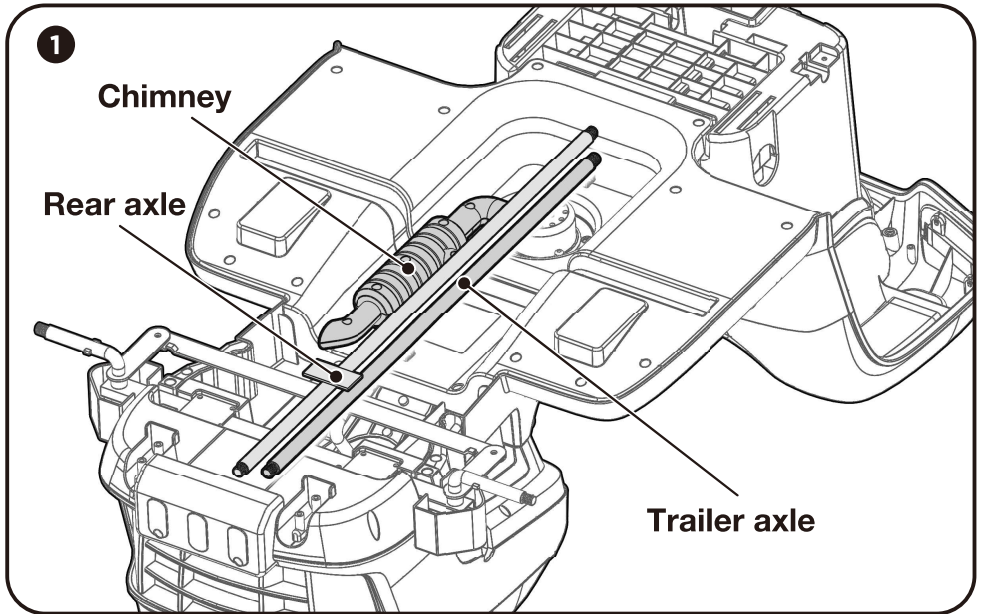

1. Turn the vehicle body downside up. Take out the chimney, rear axle and trailer axle packed under the body.
2. Fit the bull bar to the body.
3. Insert four #4x12 screws and tighten with a screwdriver.

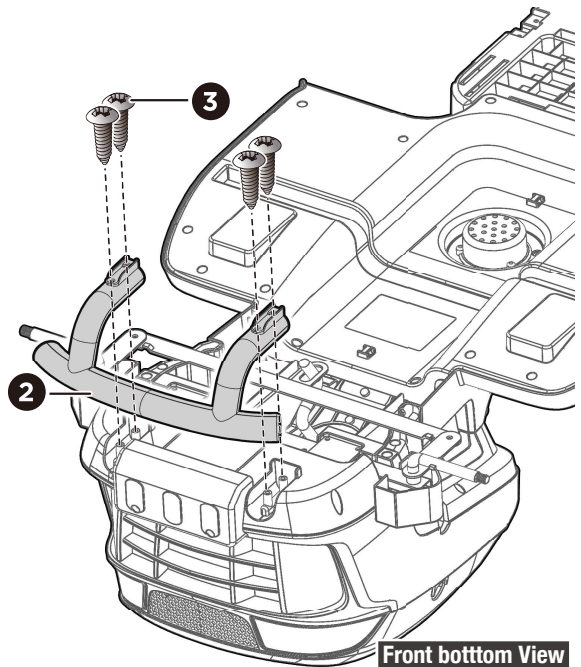

7

Assembly Instruction

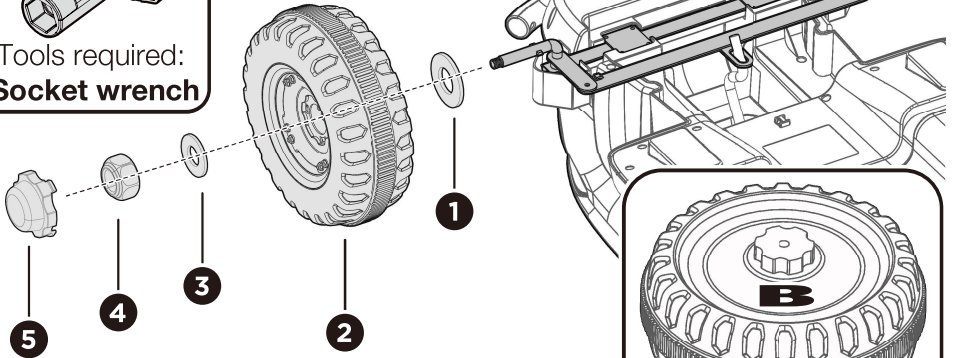
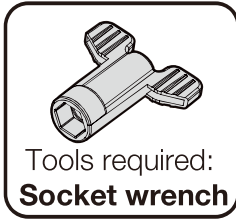

1. Slide a **M10 washer** onto the front axle.
 2. Slide a **Front wheel (Markd "B")** onto the front axle.
 3. Slide a **M8 washer** onto the front axle.
 4. Tighten a lock nut to the end of the front axle with a socket wrench (included).
 5. "Snap" the hub cap cover to the front wheel.
- Repeat for the other front wheel.

6. Insert the rear axle (the one with a square iron) through the hole in the body.
And make the square iron match up with the square groove in the body (6b).

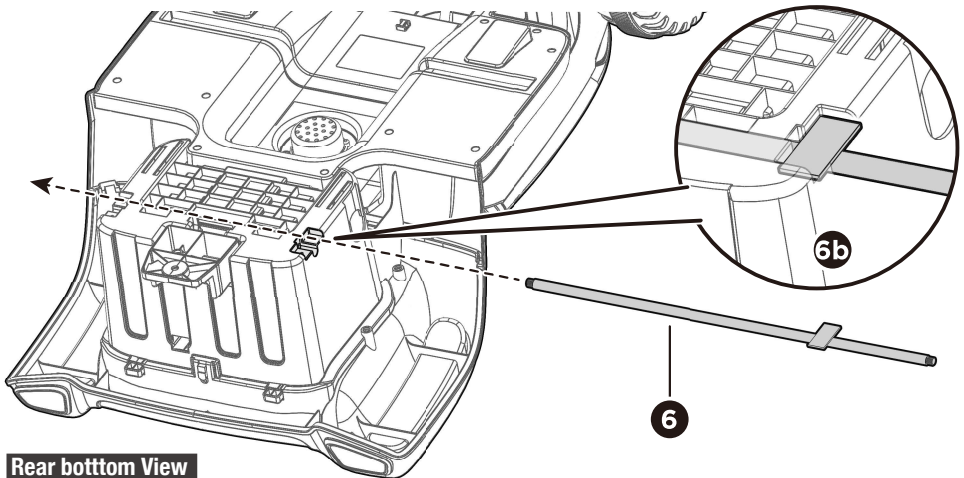

Rear bottom View

8

Assembly Instruction

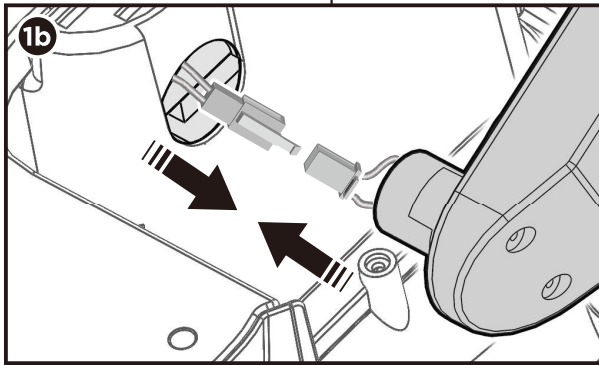
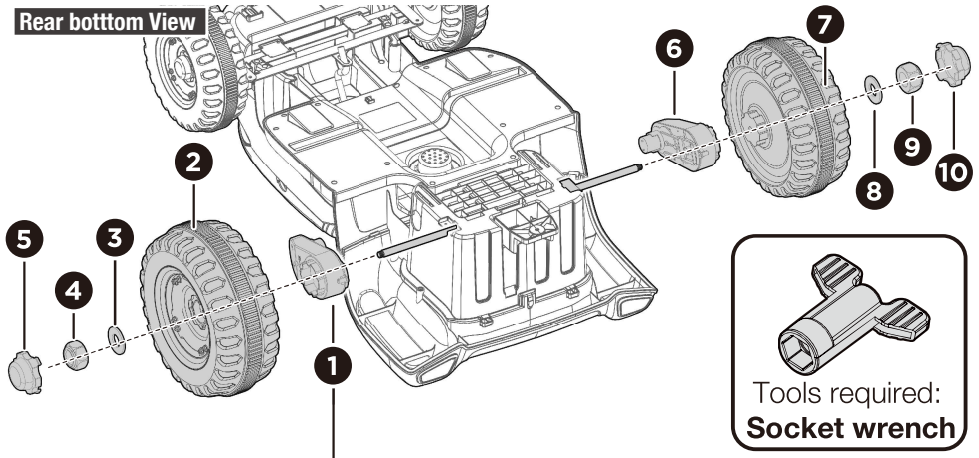

1. Fit a gear box onto the rear axle. Plug the connector on the gear box into the connector from the body (as FIG 1b), and hide the plugged connectors into the larger hole in the bod.
2. Slide a **driving wheel (Marked "A")** onto rear axle.
3. Slide a **M8 washer** onto the rear axle.
4. Tighten a locknut to the end of the rear axle with a socket wrench (included).
5. Snap the hub cap to the wheel.
- 6-10. Repeat steps 1-5 to assemble the other driving wheel.

9

Assembly Instruction

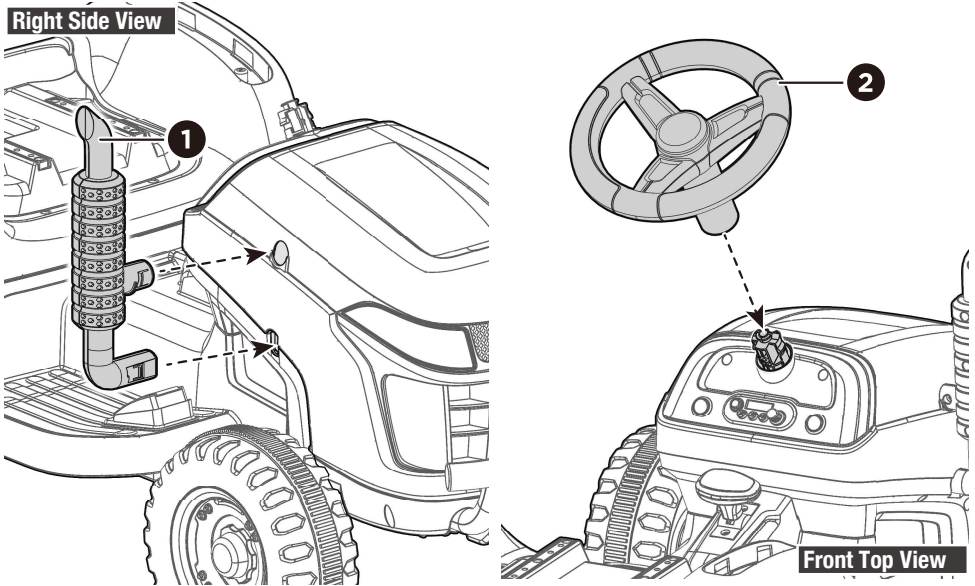

1. Fit the chimney to the body. Press firmly until it is assembled into place.
2. Fit the wheel to the steering wheel holder, push until you hear it “click” into place.
3. Fit the arm rest to the body, push until you hear it click into place. Repeat for the other side.

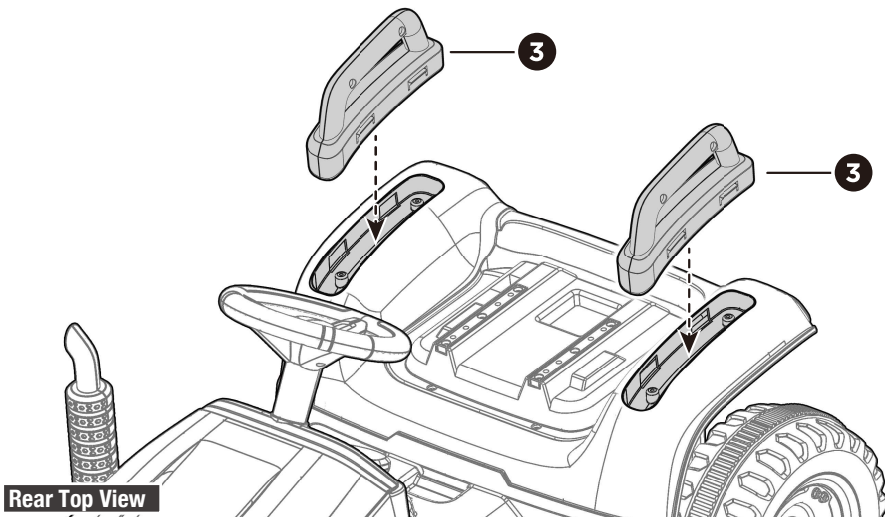

10 Assembly Instruction

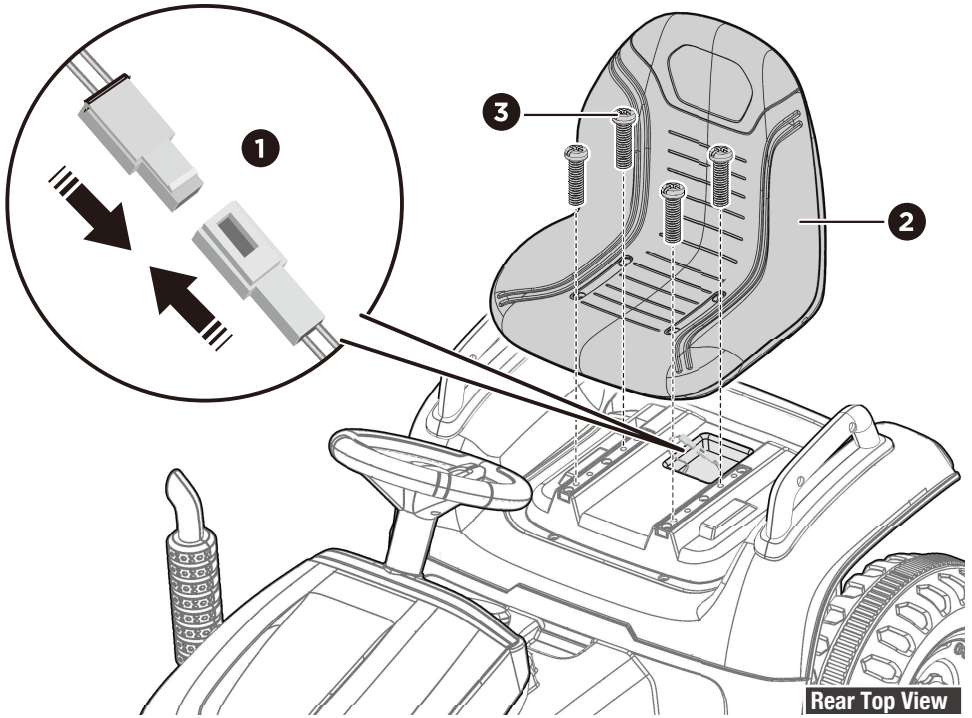

1. Plug the power connectors into each other. Press firmly.
2. Fit the seat to the body.
The seat is adjustable and have two positions. Please choose the suitable position as your child grows up.
3. Aligns the holes in the seat with the holes in the body, tighten four M4x25 screws with a screwdriver.

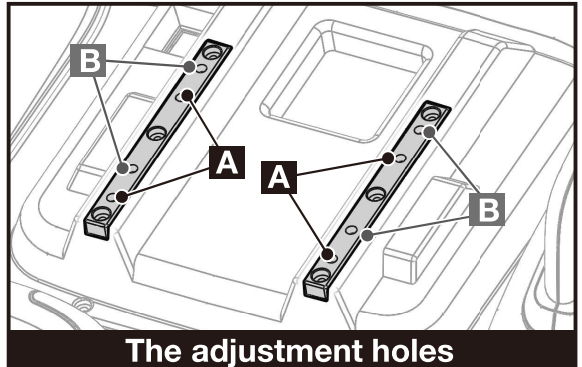

11 Assembly Instruction

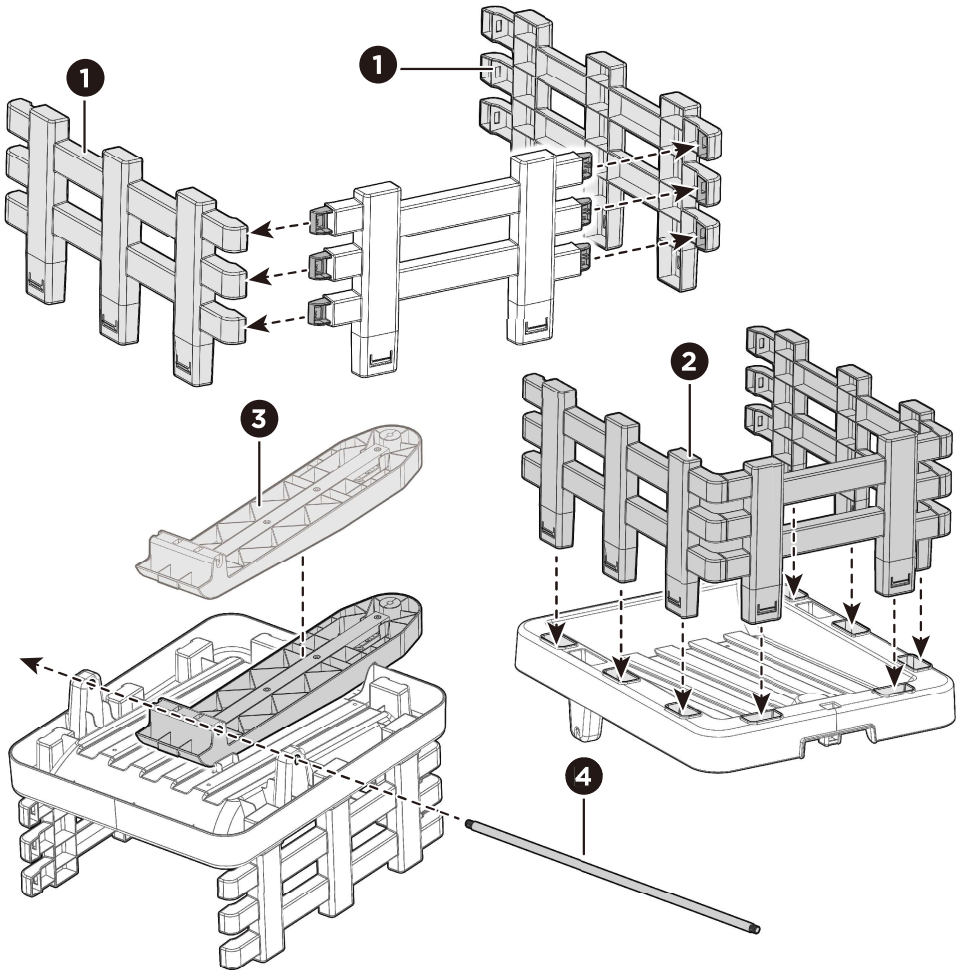

1. Fit the two side rails to the front rail.
2. Insert the tabs on the rails into the holes in the trailer body. Push until you hear them “click” into place.
3. Turn the trailer body downside up. Fit the trailer tow bar to the trailer body.
4. Insert the trailer axle through the holes in the trailer body, the holes in the tow bar and out through the holes on the other side of the trailer body.

12 Assembly Instruction



1. Slide a bushing (smaller end first) onto the trailer axle.
2. Slide a **Trailer wheel (Marked “C”)** onto the trailer axle.
3. Slide M8 washer onto the trailer axle.
4. Tighten a lock nut to the end of the trailer axle with a socket wrench.
- 5-8. Repeat steps 1-4 to assemble the other trailer wheel to the trailer axle.
9. Snap a hubcap to each wheel.

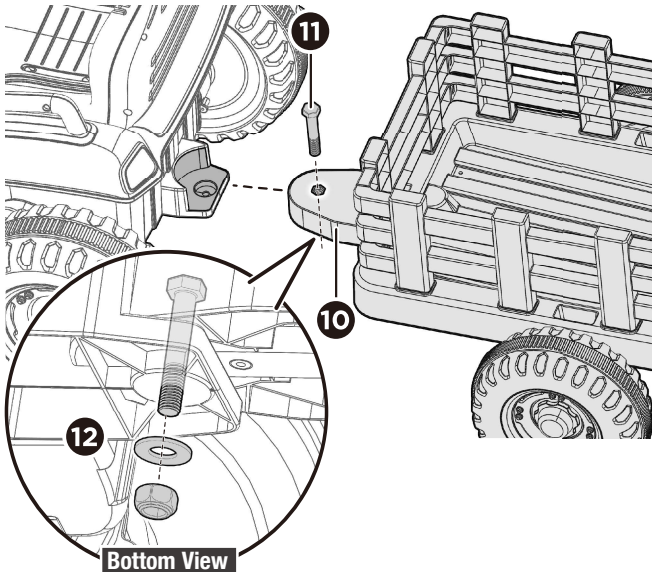
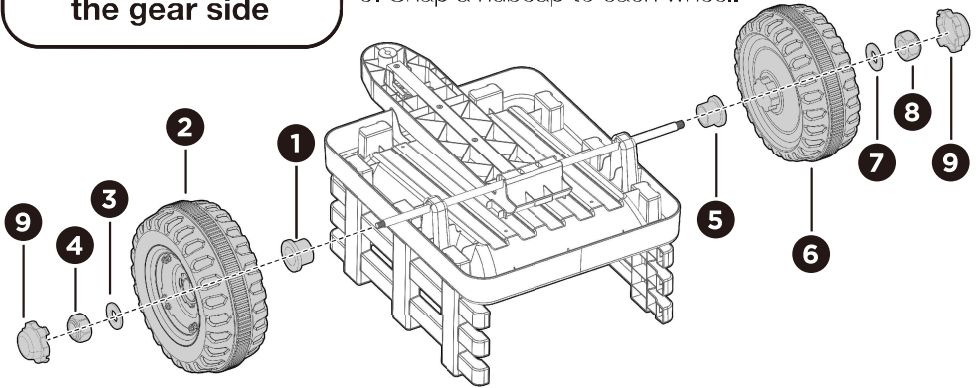

10. Fit the tow bar to the vehicle body.
11. Insert the M8x45 bolt into the holes in the tow bar and out through hole in the body.
12. Fit a M8 washer onto the bolt from the bottom side. And tighten a M8 locknut with a socket wrench.

13 Use

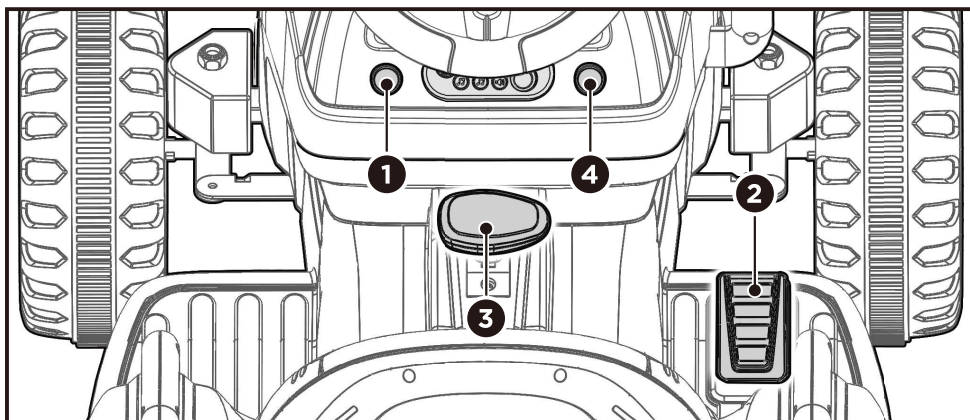

- 1. Power button:** Turn the product on and off.
- 2. Foot pedal:** Applies power (speed) to the product.
 - To move the product, press the pedal down.
 - To brake or slow down, release pressure from the pedal.
- 3. Forward/reverse lever:** Change the direction that product moves from forward to reverse.
 - To move the vehicle forward, shift the lever to top position.
 - To move the vehicle backward, shift the lever to down position.
- 4. High/Low speed switch:** Operate the product to move forward in high or low speed.
- 5. Player**

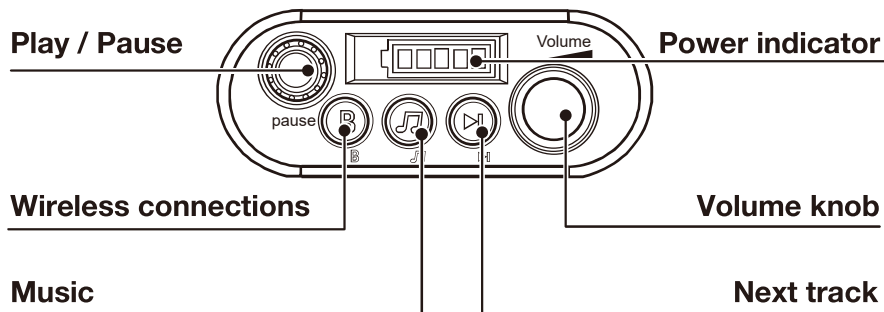

14 Use

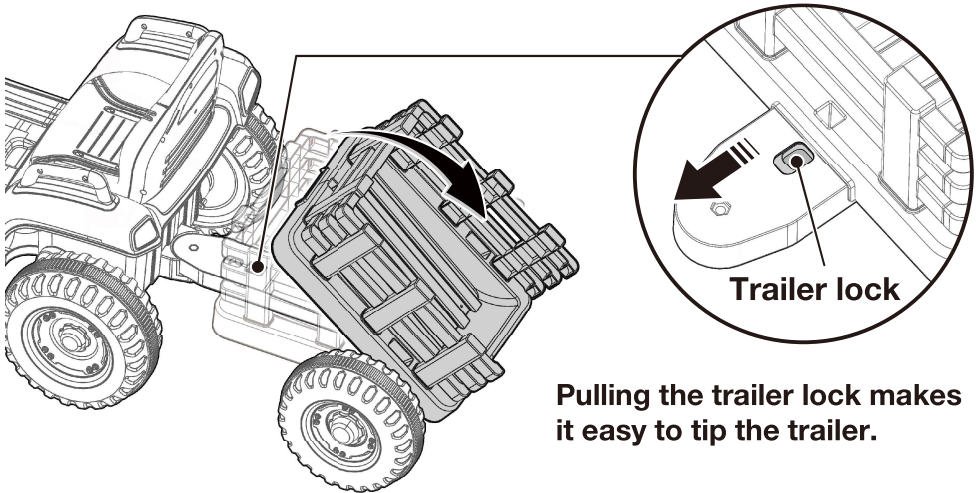

Pulling the trailer lock makes it easy to tip the trailer.

⚠ WARNING!

The remote control is not a toy. It is for the adult use only, and should not be used by a child. A close adult supervision is always required. Reception range may change significantly with weather, battery, and other environmental conditions.

Attach the battery to the remote control

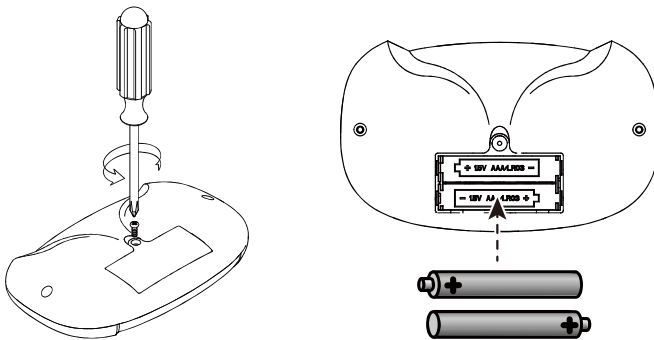

Use a screwdriver to remove the battery compartment door on the back side of the controller and insert two AAA 1.5V batteries.

HINT: Batteries not included. Refer to the Battery Information on page 2.

15 Use

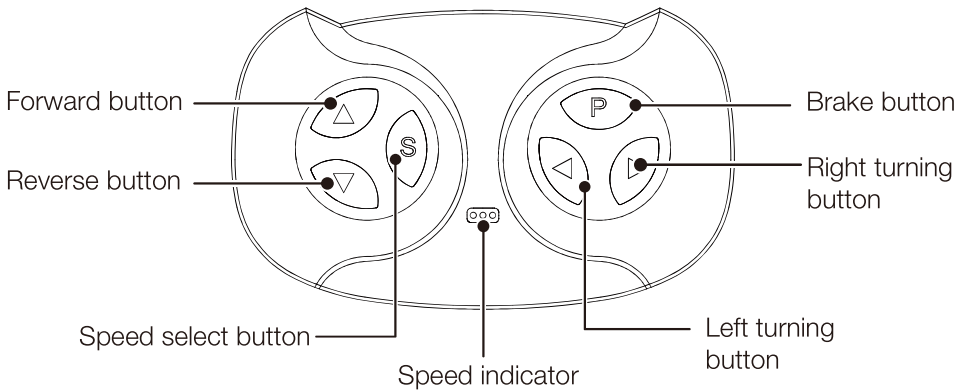

1. Build connection

- Press and hold the forward (Δ) and reverse (∇) buttons on the **controller** for 3 seconds, the speed indicator flashes, mean that the remote control is in the connected state. Then power on the **vehicle**:
- The speed indicator goes to long bright, means the connection successful.
- * If the speed indicator no response (keep flashing), means the connection failed. Turn off the remote controller (by removing the batteries) and the vehicle. And try again.

2. Brake button

Press the button to stop the vehicle, press it again to release the brake.

3. Speed select button

The switch operates the vehicle to move in low, normal and high speed.

NOTE:

- Leave the remote controller idling for about 10 seconds, it will shut down automatically.

16 Charging



⚠ WARNING!

- **ONLY an adult is allowed charge and recharge the battery!**
- **This charging protection will cut all all the functions of the vehicle when charging.**

- The vehicle must be OFF when charging.
- When the vehicle begins to run slowly, recharge the battery.
- When the product is stationary, the power indicator will tell you how much power is remaining in the battery. If only one indicator light remains, please recharge the battery.

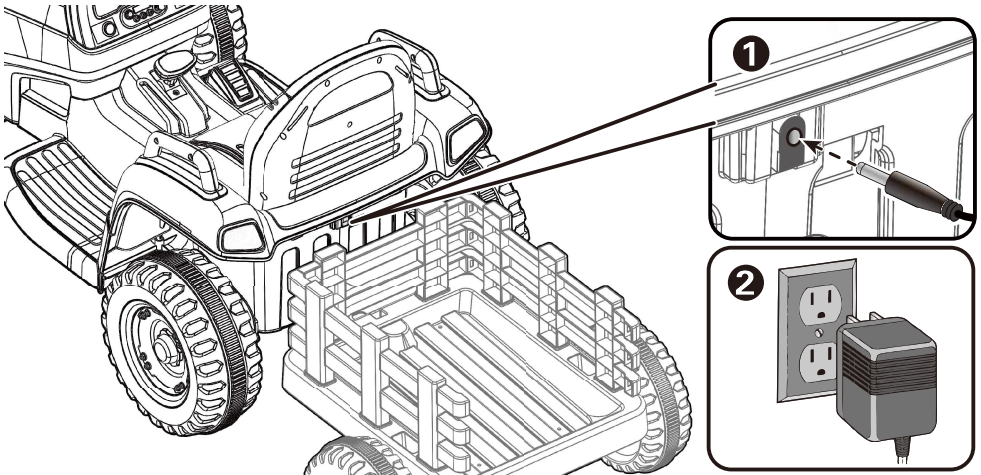

1. Plug the charger port into the input socket (located at the rear of the vehicle body).
2. Plug the charger plug into a wall outlet. The battery will begin charging.

NOTE:

- Damage to the battery may occur if it is completely drained.
- Charge the battery for about 8 - 10 hours.
- Do not charge the battery for more than 20 hours.
- **Charge the battery at least once a month even if not operating the vehicle for a long time to maximize the battery life.**
- Do not charge or store the battery upside down.
- Keep the charger and battery away from flames, sparks, or any flammables.



- It is parents' responsibility to check main parts of the toy before using, Must regularly examine for potential hazard, such as the battery, charge, cable or cord, plug, screws are fastening enclosure of other parts and that in the event of such damage, the toy must not be used until that damage had been properly removed.
- Park the vehicle indoors or cover it with a tarp to protect it from wet weather.
- Recharge the battery after each use. Only an adult can handle the battery. Recharge the battery at least once a month when the vehicle raider is not being used.
- Do not wash the vehicle with a hose. Do not wash the vehicle with soap and water. Do not drive the vehicle in rainy or snowy weather. Water will damage the motor, electric system and battery.
- Clean the vehicle with a soft, dry cloth. To restore shine to plastic parts, use a non-wax furniture polish. Do not use car wax. Do not use abrasive cleaners.
- When not using, all the electrical source should be turn off. Turn off the power switch and disconnect the battery connection.

Fuse

The battery features a thermal fuse with a reset fuse that will automatically trip and cut all power to the vehicle if the motor, electric system or battery is overloaded. The fuse will reset and power will be restored after the unit is turned OFF for 20 seconds and then turned ON again. If the thermal fuse trips repeatedly during normal use, the vehicle may need repair. Contact after-sales service center.

To avoid losing power, follow these guidelines:

- Do not overload the vehicle.
- Do not tow anything behind the vehicle.
- Do not drive up steep slopes.
- Do not drive into fixed objects, which may cause the wheels to spin, causing the motor to overheat.
- Do not drive in very hot weather, components may overheat.
- Do not allow water or other liquids to come in contact with the battery or other electric components.
- Do not tamper with the electric system. Doing so may create a short, causing the fuse to trip.



RISK OF FIRE. Do not bypass. Replace only with a new fuse.



Problem	Possible Cause	Solution
Vehicle does not run	Battery low on power	Recharge battery.
	Thermal fuse has tripped	Reset fuse, see <Fuse>
	Battery connector or wires are loose	Check that the battery connectors are firmly plugged into each other. If wires are loose around the motor, please contact after-sales service center.
	Battery is dead	Replace battery, please contact after-sales service center.
	Electrical system is damaged	Please contact after-sales service center.
	Motor is damaged	Please contact after-sales service center.
Vehicle does not run very long	Battery is under charged	Check that the battery connectors are firmly plugged into each other when recharging
	Battery is old	Replace battery, please contact after-sales service center.
Vehicle runs sluggishly	Battery low on power	Recharge battery, please contact after-sales service center.
	Battery is old	Replace battery, please contact after-sales service center.
	Vehicle is overload	Reduce weight on vehicle.
	Vehicle is being used in harsh conditions	Avoid using vehicle in harsh conditions, see <User Notice>.



Vehicle needs a push to go forward	Poor contact of wires or connectors	Check that the battery connectors are firmly plugged into each other. If wires are loose around the motor, please contact after-sales service center.
	“Dead Spot” on motor	A dead spot means the electric power is not being delivered to the terminal connection and the vehicle needs repair. Please contact after-sales service center.
Difficult shifting from forward to reverse or vice-versa	Attempting to shift while the vehicle is motion	Completely stop the vehicle and shift, see <Use>
Loud grinding or clicking noises coming from motor or gear box	Motor or gears are damaged	Please contact after-sales service center.
Battery will not recharge	Battery connector or adapter connector is loose	Check that the battery connectors are firmly plugged into each other.
	Charger not plugged in	Check that the battery charger is plugged into a working wall outlet.
	Charger is not working	Please contact after-sales service center.
Charger feels warm when recharging	This is normal and not a cause for concern	

Completely read through this manual and the troubleshooting guide table before calling. If you still need help for resolving the problem, please contact after-sales service center.

20

Use the RC-Manual switch



RC

How to switch the product to Remote Control mode.

- This product is only controlled by the remote controller in RC mode.

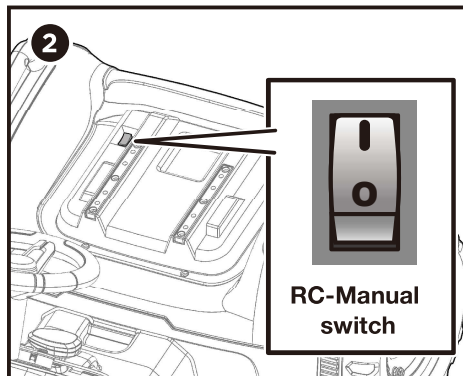
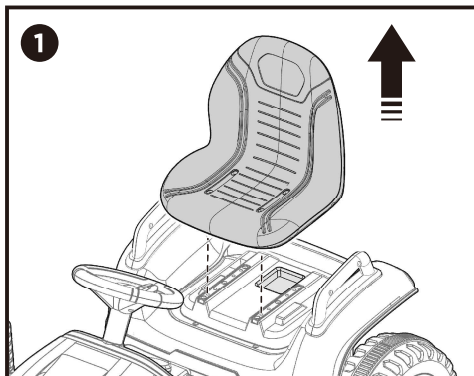

1. Remove the seat with a screwdriver.
2. Press the RC-Manual switch to “ I ” (RC).
3. Replace the seat.

M

How to switch the product back to Manual mode

- This product is only controlled by the driver in Manual mode.



1. Remove the seat.
2. Press the RC-Manual switch to “ O ” (Manual).
3. Replace the seat.

WARNING!

The remote control is not a toy. It is for the adult use only, and should not be used by a child. A close adult supervision is always required. Reception range may change significantly with weather, battery, and other environmental conditions.